

BRINE PUMP PROBLEMS?



Corrosive brine destroys conventional vacuum pumps.
Resulting replacement schedules become an expensive routine.

The solution is simple...

CLP-190 by **EDCO USA**[®]

- specifically designed for removing excess brine from pouches
- CPVC body and stainless steel components
- rugged design for corrosive liquids
- no moving parts
- self draining
- low air consumption

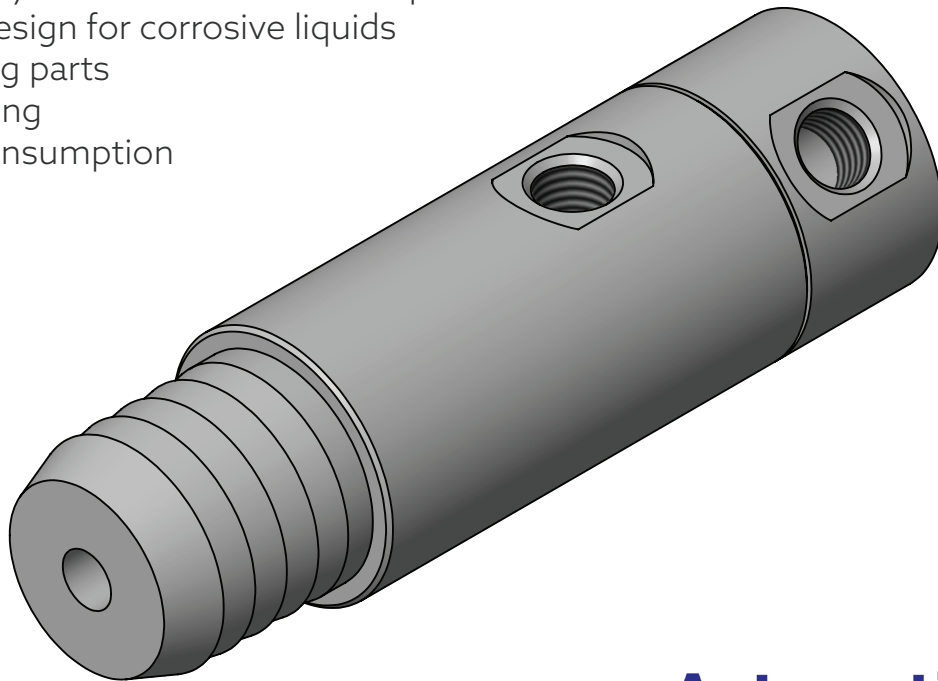

EDCO USA[®]

www.edcousa.net
+1 (636) 349-2632

**Automation
Solutions**^{of WI, Inc.}
Innovative Solutions by Design

www.autosolwi.com
+1 (262) 243-0103

CLP-190 by **EDCO USA**[®]

Mount this end up
for self draining.

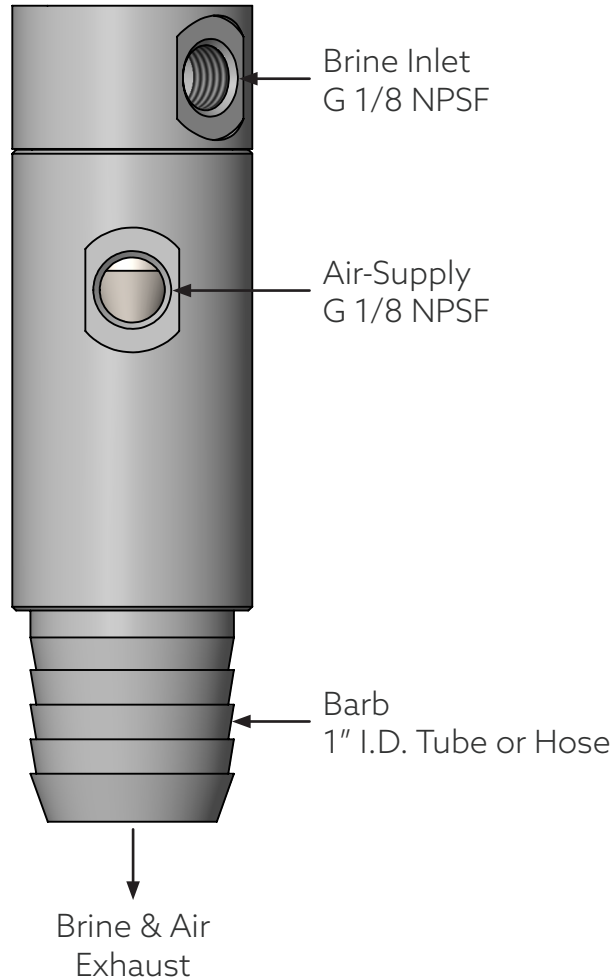

Brine & Air
Exhaust

Vacuum	Air Pressure	Air Consumption
15 inHg (0.5 bar)	36 psi (2.5 bar)	5.0 scfm (142 NI/m)
18 inHg (0.6 bar)	44 psi (3.0 bar)	6.0 scfm (170 NI/m)
24 inHg (0.8 bar)	72 psi (5.0 bar)	8.5 scfm (240 NI/m)



www.edcousa.net
+1 (636) 349-2632



www.autosolwi.com
+1 (262) 243-0103